

UNIVERSAL COUPLING MODEL SWP (JB3241-91)

Normal type

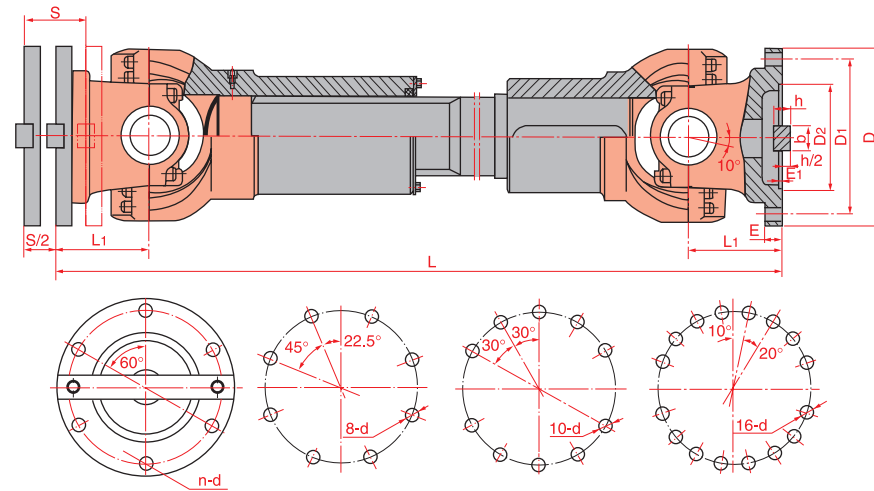

Type A
Long flexible type

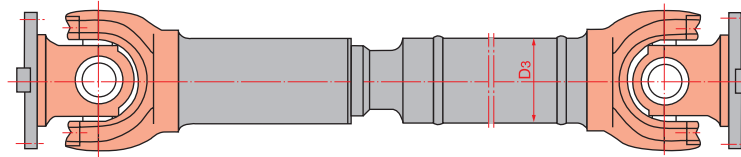

Type B
Short flexible type

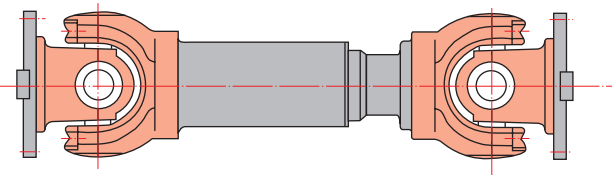

Type C
Short non-flexible

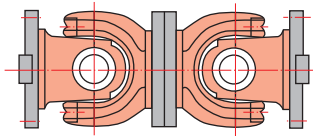

Type D
Long non-flexible

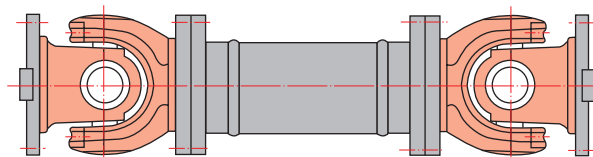

Type E
Long flexible double flange type

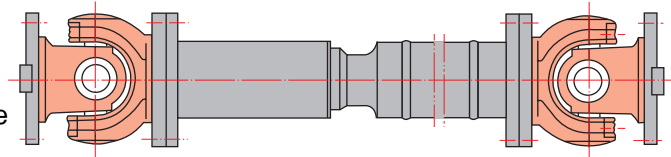

Parameters and Specifications of Coupling Model SWP

Table 1

Model	Gyration dia. D	Nominal angular force Tn kN·m	Fatigue angular force TK kN·m	Axis angle $\beta <$	Standard dilation S	Dimensions mm								
						D1	D2 H7	D3	E	E1	b × h	$\frac{h}{2}$	L1	n-d
SWP160 □ -91	160	16	8	10°	50	140	95	114	15	4	20 × 12	6	85	6-13
SWP180 □ -91	180	20	10	10°	60	155	105	121	15	4	24 × 14	7	95	6-15
SWP200 □ -91	200	31.5	16	10°	70	175	125	127	17	5	28 × 16	8	110	8-15
SWP225 □ -91	225	40	20	10°	75	196	135	152	20	5	32 × 18	9	130	8-17
SWP250 □ -91	250	63	31.5	10°	80	218	150	168	25	5	40 × 25	12.5	135	8-19
SWP285 □ -91	285	90	45	10°	100	245	170	194	27	7	40 × 30	15	150	8-21
SWP315 □ -91	315	126	63	10°	110	280	185	219	32	7	40 × 30	15	170	10-23
SWP350 □ -91	350	180	90	10°	120	310	210	245	35	8	50 × 32	16	185	10-23
SWP390 □ -91	390	250	120	10°	120	345	235	273	40	8	70 × 36	18	205	10-25
SWP435 □ -91	435	355	160	10°	150	385	255	299	42	10	80 × 40	20	235	16-28
SWP480 □ -91	480	450	224	10°	170	425	275	351	47	12	90 × 45	22.5	265	16-31
SWP550 □ -91	550	710	355	10°	190	492	320	402	50	12	100 × 45	22.5	290	16-31
SWP600 □ -91	600	1000	500	10°	210	544	380	450	55	15	90 × 55	27.5	330	22-34
SWP640 □ -91	640	1250	630	10°	230	575	385	480	60	15	100 × 60	30	350	18-38

Note: (1)The squares in models stand for types of couplings, i.e.A, B, C, D, or E Blank squares for basic types.

(2)Flange dia. of both ends of standard couplings are same as the gyration dia. Flange dia. may be increased by 1~2 grade or willfully on customers' requests.

(2)Couplings with excessive flex may be manufactured on customers' requests.

Table 2

Type	Parameters	Gyration dia.														
		160	180	200	225	250	285	315	350	390	435	480	550	600	640	
Basic type	Lmin	610	700	780	928	958	1103	1240	1400	1480	1740	1940	2125	2400	2700	
	Weight G(kg)	60	75	98	135	168	273	367	515	645	1214	1497	2053	2730	3700	
	On every weight increase of 100Kg	3.2	3.8	4.8	6.4	7.7	9.6	12.1	15.8	15.8	24.7	27.1	32.6	50	65	
Type A	Lmin	660	737	823	933	978	1133	1250	1380	1495	1710	1910	2135	2355	2685	
	Weight G(kg)	57	70	91	119	157	255	345	458	596	962	1394	1944	2530	3453	
	On every weight increase of 100Kg	3	3.2	4.4	6.6	7.3	9.4	12	15.9	18	20	28	35.7	40.5	48.3	
Type B	L	585	640	730	830	860	1000	1120	1230	1310	1555	1740	1905	2100	2240	
	Weight G(kg)	54	66	85	116	148	249	329	438	557	953	1343	1745	2440	2850	
Type C	L	340	380	440	520	540	600	680	740	820	940	1060	1160	1320	1400	
	Weight G(kg)	38	50	70	90	130	185	250	330	472	760	1000	1400	1480	2700	
Type D	Lmin	430	474	544	636	690	760	860	940	1060	1180	1360	1460	1720	1790	
	Weight G(kg)	45	57	77	104	155	220	291	375	531	855	980	1700	2343	3240	
	On every weight increase of 100Kg	3	3.2	4.4	6.6	7.3	9.4	12	15.9	18	20	28	35.7	40.5	48.3	
Type E	Lmin	715	800	880	1000	1055	1210	1345	1480	1630	1860	2122	2338	2640	2960	
	Weight G(kg)	59	79	95	121	189	305	395	518	693	1267	1452	2260	2820	3921	
	On every weight increase of 100Kg	3	3.2	4.4	6.6	7.3	9.4	12	15.9	18	20	28	35.7	40.5	48.3	